



CONSTRUCTION AND FACILITY SERVICES (CFS)
3200 Center Street, Houston TX 77007-5909

Facilities Planning

Project Advisory Team Meeting Minutes
Parker Elementary School

MEETING: 007

LOCATION: Parker Elementary School

DATE / TIME: March 26, 2014, 3:30 PM

ATTENDEES: Steven Redmond, HISD Program Manager, (URS); Cindy Chapman, Parent – Community Rep; Lori Frodine, Principal; Heather Grosso, Faculty; LaJuan Harris, HISD/Facilities Planner; Dale Harrison, Faculty; Peter Ho, Brave/Architecture; Gregory Kabay, Faculty; Carol Kehlenbrink, PES Magnet Coord; Kathryn Rodgers, Faculty; Susan Shafer, Librarian; Christian Sheridan, Brave/Architecture; Rachel Theurer, Parent; Alean Zufall, PES Secretary; Albert Wong, HISD Design; 6 students from the school

PURPOSE: This meeting was called to review space relationships and the conceptual development of site and floors for the new school.

AGENDA ITEMS:

- Introductions
- Parker Students – “Time with the Architects”
- Introduction of Brave/Architecture
- Discussions with the Architects
 - Conceptual Site Plan
 - Conceptual Floor Organization
- What to expect at the next PAT meeting

NOTES:

Discussion:

1. Five Parker students were included in the PAT meeting. The students provided input on the new school to the architect:
 - a. We need larger Chorus Room – the students are crowded in the existing room, they need a little personal space.
 - b. The Instrument Room needs to be larger. The existing room is cramped; violin players are always bumping into one another.

Customer Focused . . . Always Responsive!

Office: 713-556-9299

Fax: 713-676-9582

- c. We need to separate the cafeteria from the auditorium. A discussion followed on how performances might work in a new space, and how a stage might be arranged for performances to the outside and flipped to perform to an inside audience.
 - d. A Warm-Up room is needed adjacent to the Auditorium with instrument storage space, so students do not have to run back and forth from class/music rooms to the performance space.
 - e. The library needs to be zoned for age appropriate materials; for example; provide zones for pre-K thru 1; second and third grades; fourth and fifth grades.
 - f. Connect a garden to the classrooms for outdoor learning and experiments.
 - g. Don't paint the Girls Restroom pink.
 - h. The new school should be Eco-Friendly.
 - i. The new school should have operable windows.
 - j. The new School should have environmental controls.
2. Architect presented the conceptual site layout and floor organizations and discussed how the comments and recommendations from the charette had been incorporated into the work.
3. Handouts of the plans and diagrams were provided for all attendees (see attached). PAT members are to review and submit questions and comments to HISD.

ACTION ITEMS:

07-01 Review handouts and provide feedback by April 3rd.to Principal Frodine (PAT).

NEXT MEETING:

The next meeting will be on April 23, 2014 @ 3:30 PM

Please review these meeting minutes and submit any changes or corrections to Steven Redmond. After five (5) days, the minutes will be assumed to be accurate.

Sincerely,

Steven Redmond, AIA, Program Manager
HISD – Construction & Facility Services
3200 Center Street, Houston, TX 77007
Phone: (713) 556-9423
Mobile: (713) 277-4400
Sredmon1@houstonisd.org; Steven.redmond@urs.com

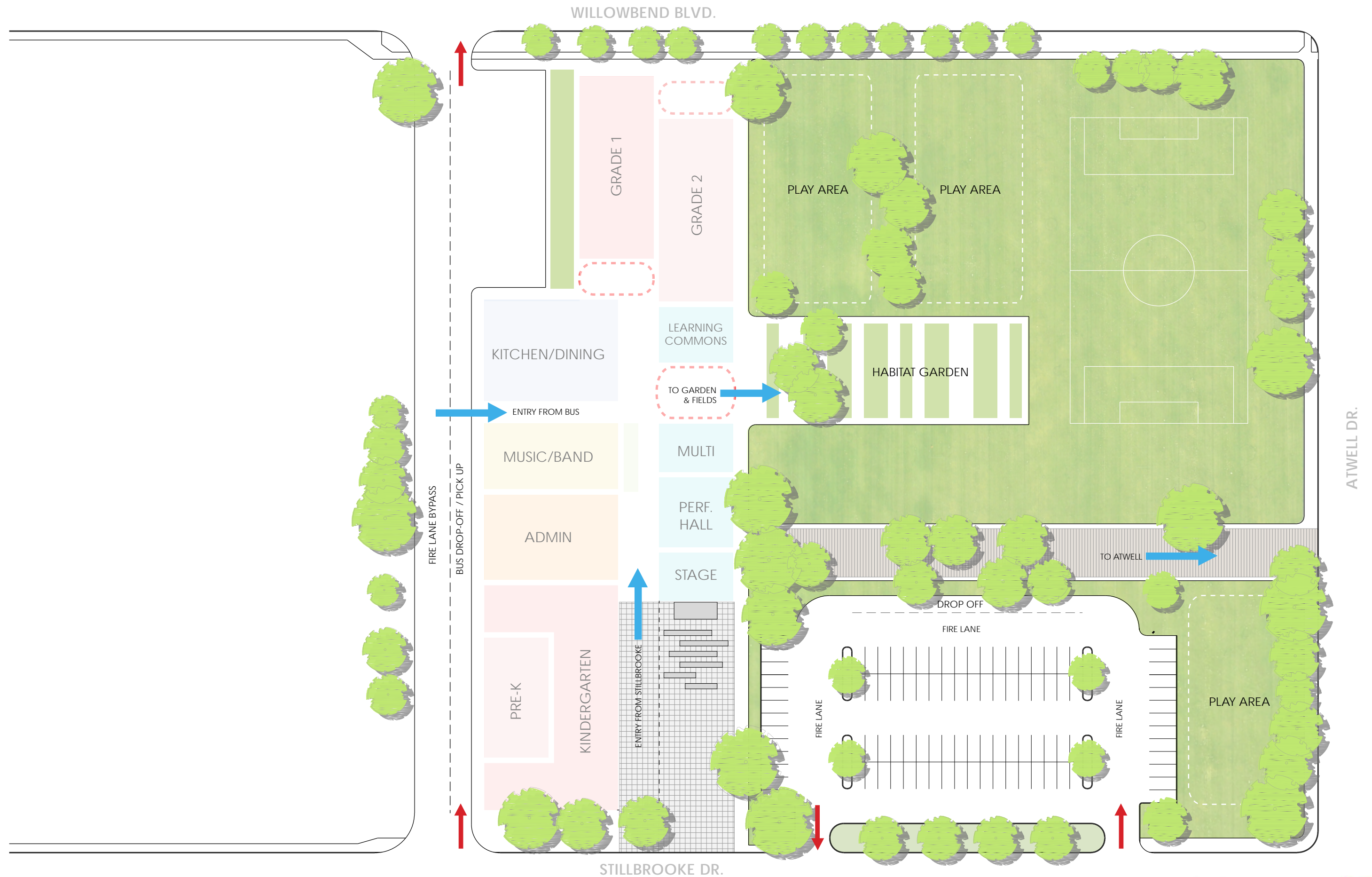

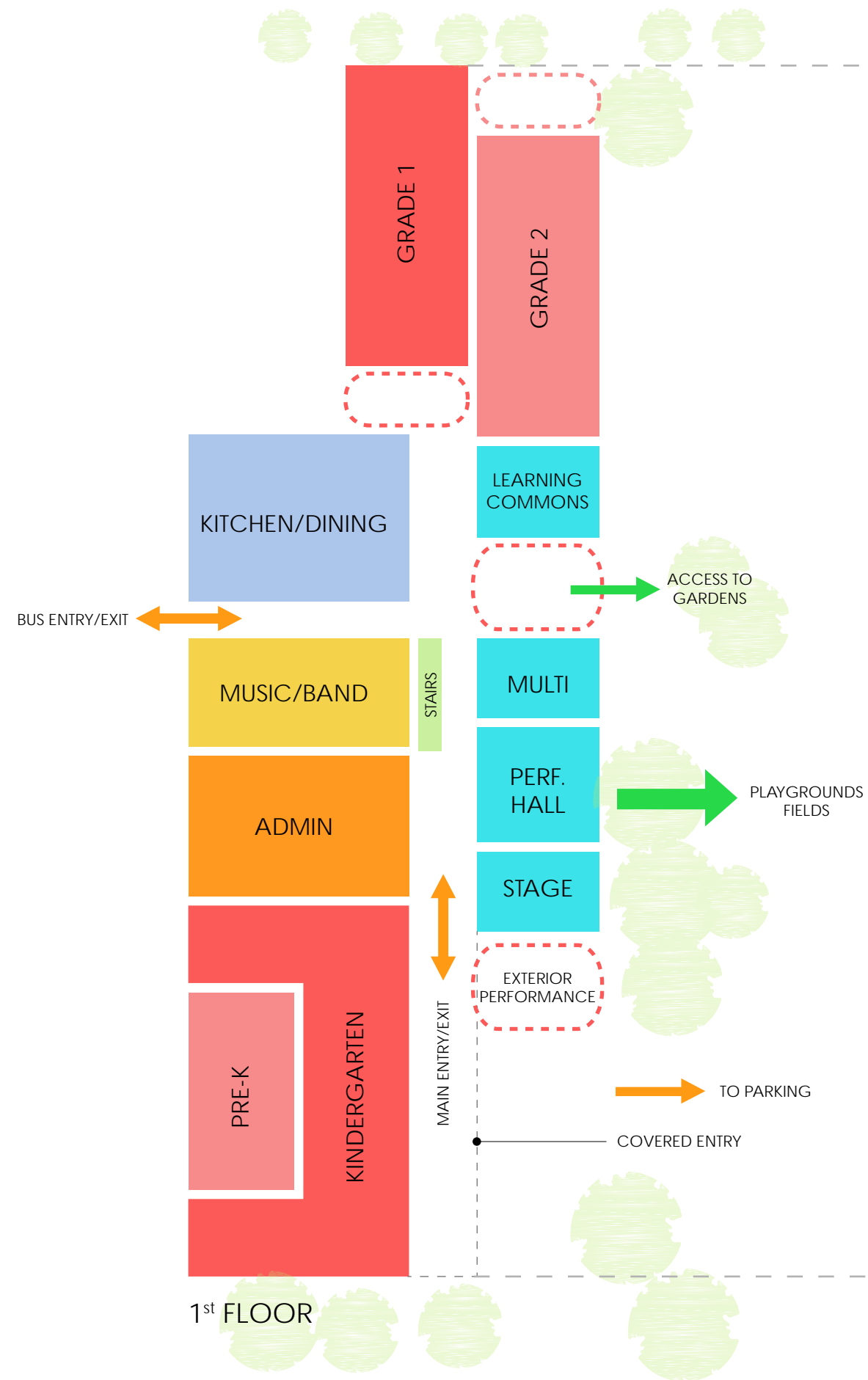

H.I.S.D. PARKER ELEMENTARY SCHOOL

MARCH 26, 2014

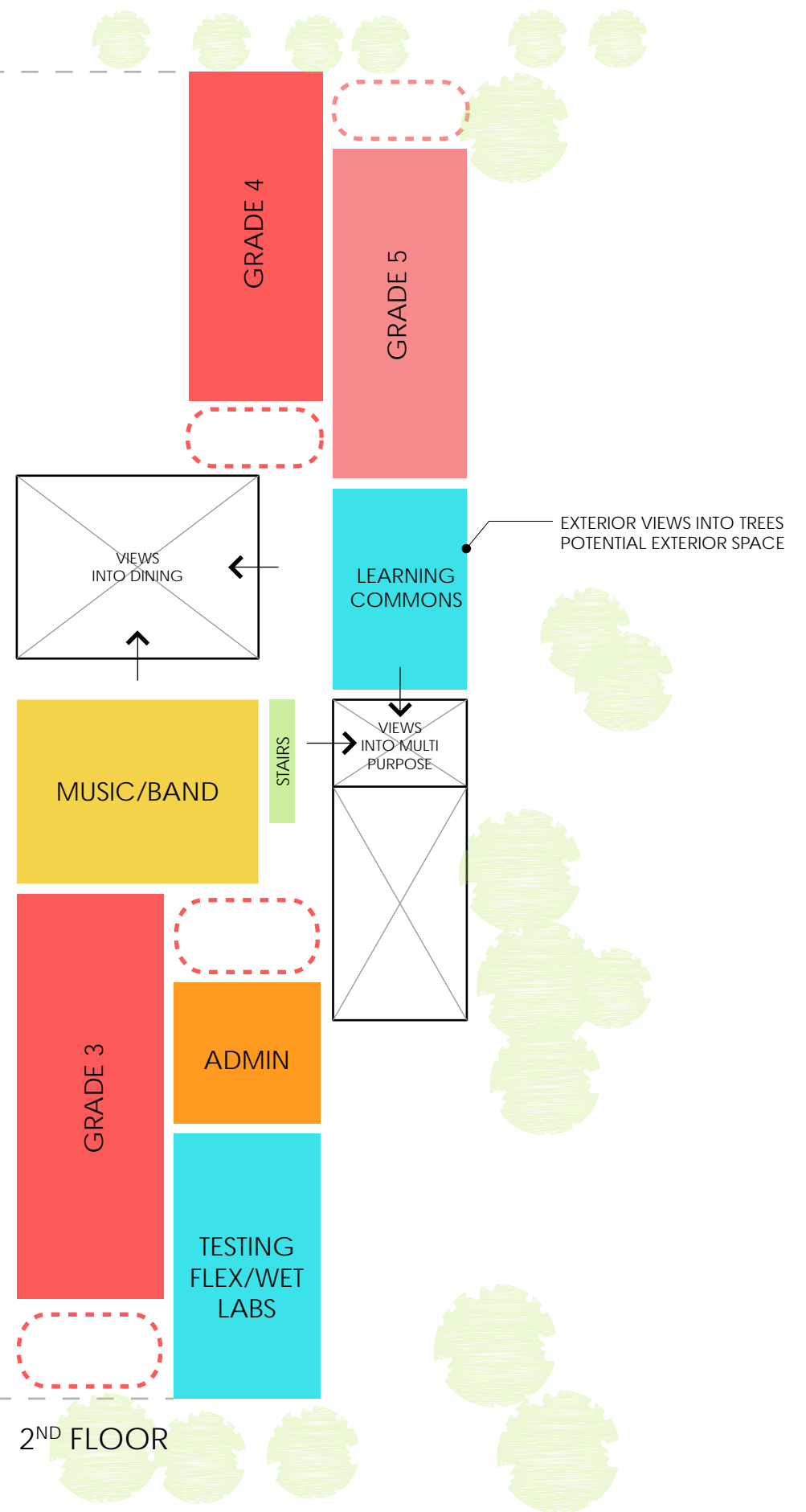

~~Parker Elementary~~ Ideas

1. chorus room 4x bigger !big!
2. separate cafeteria & auditorium
3. bigger library
4. 2 stories shaped like a U
(garden in center, so put science classes on the inside near the garden) Green house
5. a gym instead of a mini gym
6. pool (half indoor, half outdoor)
7. larger class rooms
8. science lab (cheat)
9. Real LOCKING stalls in restroom
& bigger, more mirrors
10. locker rooms
11. 1st floor (K-3) 2nd floor (4-5)

12. back stages in the new auditorium

13. bigger, better playgrounds (swings)
merry-go-round

14. better tutoring rooms (bigger)

15. Bigger Snack Vending Machines

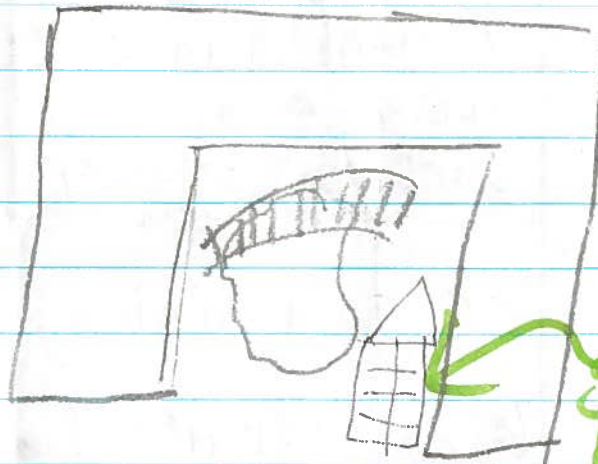

green
house

20. doors
to the
restrooms

~~21.~~
17. Don't paint the Girls restroom in pink, try!!
well if you'll paint the restrooms, make
the girls a more natural color like...
green! or **Random!**

18. **Every class has a section**
of the garden.

19. **Eco-Friendlier environment**

ext. the recycling bins are bigger and only
teachers can grant access to the trashcans to
see if it is actual trash

21. automatic sinks.

22. bigger front office / staff offices

23. sinks by the door of the cafeteria and water fountains

24. parking lot and drop off spot

25. open windows